



HI TECH TERMITE CONTROL
ADVANCED MICROWAVE TECHNOLOGY

21063 CABOT BLVD. #6 HAYWARD, CA 94545
1-800-322-0089 FAX 510-661-4218
www.hitechtermitecontrol.com

FAX COVER SHEET

TO: Katrina Edwards FAX NO: @50 813-9413

PHONE NO.: _____

FROM: Rosemary FAX NO: (510) 661-4218

PHONE NO.: (510) 661-4210

DATE: 5-2-06 NO. OF PAGES
(Including Cover): 9

MESSAGE: report, invoice and

bid w/ agreement for

1035 Newhall St. San Jose

95128

WOOD DESTROYING PESTS AND ORGANISMS INSPECTION REPORT

Building No. 1035	Street NEWHALL ST.	City SAN JOSE	Zip 95128	Date of inspection 5/1/2006	Number of Pages 6
----------------------	-----------------------	------------------	--------------	--------------------------------	----------------------

Hi Tech Termite Control of the Bay Area
21063 Cabot Blvd. #6
Hayward CA 94545
 Tel 888-322-8889 Fax 510-661-4218 Alt 510-661-4210

Report #: 14796
 Registration #: PR 4138
 Escrow #:

Ordered by: KATRINA EDWARDS 1035 NEWHALL ST. SAN JOSE, CA 95128	Property Owner and/or Party of Interest: CHRISTOPHER HARTMAN 1035 NEWHALL ST. SAN JOSE CA 95128 KATRINA EDWARDS 1035 NEWHALL ST. SAN JOSE, CA 95128	Report sent to: KATRINA EDWARDS 1035 NEWHALL ST. SAN JOSE, CA 95128
--	---	--

COMPLETE REPORT LIMITED REPORT SUPPLEMENTAL REPORT REINSPECTION REPORT

GENERAL DESCRIPTION: 1 STORY WOODSIDING AND FRAME RESIDENCE FURNISHED AND OCCUPIED WITH A COMPOSITION ROOF ATTACHED GARAGE UNIMPROVED UNDER AREA AND SLEEPER.

Inspection Tag Posted: SUBAREA
 Other Tags Posted:

An inspection has been made of the structure(s) shown on the diagram in accordance with the Structural Pest Control Act. Detached porches, detached steps, detached decks and any other structures not on the diagram were not inspected.

Subterranean Termites Drywood Termites Fungus / Dryrot Other Findings Further Inspection
 If any of the above boxes are checked, it indicates that there were visible problems in accessible areas. Read the report for details on checked

Diagram Not To Scale

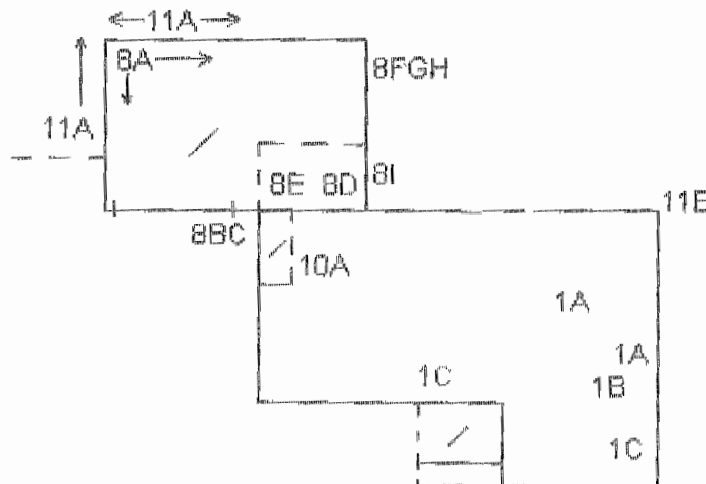

Front

Inspected By: JOHN PAUL WILLIAMS State License No. OPR 10185 Signature: *John P. Williams*

You are entitled to obtain copies of all reports and completion notices on this property reported to the Structural Pest Control Board during the preceding two years. To obtain copies contact: Structural Pest Control Board, 1418 Howe Avenue, Suite 18, Sacramento, California, 95825-3204.

NOTE: Questions or problems concerning the above report should be directed to the manager of the company. Unresolved questions or problems with services performed may be directed to the Structural Pest Control Board at (916) 561-8708, (800) 737-8188 or www.pestboard.ca.gov.

Hi Tech Termite Control of the Bay Area

Page 2 of inspection report

1035	NEWHALL ST.	SAN JOSE	CA	95128
Address of Property Inspected		City	State	Zip
Stamp No.	5/1/2006	14796	Escrow No.	
	Date of Inspection	Co. Report No.		

WHAT IS A WOOD DESTROYING PEST & ORGANISM INSPECTION REPORT? READ THIS DOCUMENT. IT EXPLAINS THE SCOPE AND LIMITATIONS OF A STRUCTURAL PEST CONTROL INSPECTION AND A WOOD DESTROYING PEST & ORGANISM INSPECTION REPORT.

A Wood Destroying Pest & Organism Inspection Report contains findings as to the presence or absence of evidence of wood destroying pests and organisms in visible and accessible areas and contains recommendations for correcting any infestations or infections found. The contents of Wood Destroying Pest & Organism Inspection Reports are governed by the Structural Pest Control Act and regulations.

Some structures do not comply with building code requirements or may have structural, plumbing, electrical, mechanical, heating, air conditioning or other defects that do not pertain to wood destroying organisms. A Wood Destroying Pest & Organism Inspection Report does not contain information on such defects, if any, as they are not within the scope of the licenses of either this company, or its employees.

The exterior Surface of the roof was not inspected. If you want the water tightness of the roof determined, you should contact a roofing contractor who is licensed by the Contractor's State License Board.

This company does not certify or guarantee against any leakage, such as (but not limited to) plumbing, appliances, walls, doors, windows, any type of seepage, roof or deck coverings. This company renders no guarantee, whatsoever, against any infection, infestation or any other adverse condition which may exist in such areas or may become visibly evident in such area after this date. Upon request, further inspection of these areas would be performed at an additional charge.

All pesticides and fungicides must be applied by a state certified applicator (see 8555 Business and Professions Code Division 3) and in accordance with the manufacturer's label requirements.

NOTICE: Reports on this structure prepared by various registered companies should list the same findings (i.e. termite infestations, termite damage, fungus damage, etc.). However, recommendations to correct these findings may vary from company to company. You have a right to seek a second opinion from another company.

This Wood Destroying Pest & Organisms Report **DOES NOT INCLUDE MOLD** or any mold like conditions. No reference will be made to mold or mold-like conditions. Mold is not a Wood Destroying Organism and is outside the scope of this report as defined by the Structural Pest Control Act. If you wish your property to be inspected for mold or mold like conditions, please contact the appropriate mold professional.

THERE ARE CERTAIN AREAS OF A STRUCTURE WHICH ARE CONSIDERED IMPRACTICAL FOR INSPECTION: THE INTERIOR OF HOLLOW WALLS, BETWEEN FLOORS, UNDER DECKS THAT HAVE A CLEARANCE OF LESS THAN 18 INCHES OR THAT ARE HEAVILY INSULATED, FOOTINGS UNDER COLUMNS OR ARCH ABUTMENTS, RAT PROOF SUB AREAS, INSULATED SUB FLOORING, AREA UNDER FLOOR COVERINGS, UNDER OR BEHIND HOME FURNISHINGS, INSIDE BOXED EAVES, INSIDE WOOD PORCHES, SOFFITS. THESE AREAS ARE CONSIDERED TO BE INACCESSIBLE AT THE TIME OF INSPECTION.

IF THIS COMPANY FINDS EVIDENCE OF DRYWOOD TERMITES LEADING INTO WALL VOID FRAMING, THE WALL VOID WILL BE EXAMINED BY THE USE OF A FIBER OPTIC SCOPE AND FURTHER RECOMMENDATIONS WILL BE MADE FOR TREATING THOSE AREAS WITH MICROWAVES, FOAM INJECTION, OR BY FUMIGATION

THIS COMPANY CANNOT BE RESPONSIBLE FOR ANY LEAKS OR OTHER ADVERSE CONDITIONS WHICH MAY DEVELOP IN INACCESSIBLE AREAS AND BECOME VISIBLY EVIDENT AFTER THE DATE OF INSPECTION THIS COMPANY, HOWEVER, DOES WARRANTY THE ENTIRE STRUCTURE FOR THREE (3) FULL YEARS FROM THE DATE OF COMPLETION FOR ALL DRYWOOD TERMITE AND SUBTERRANEAN TERMITE INFESTATIONS UNDER OUR PRIMARY TREATMENT.

AT OWNERS REQUEST SECONDARY/SUBSTANDARD RECOMMENDATIONS CAN BE MADE FOR THE TREATMENT OF THIS STRUCTURE.

SECOND STORY STALL SHOWER STALLS ARE INSPECTED, BUT THEY ARE NOT TESTED, UNLESS THERE IS EVIDENCE OF LEAKS IN THE CEILING BELOW.

ADDITIONAL NOTES OR REMARKS:

THE MICROWAVE/BORATE INJECTION PROCESS IS NOT A FULL STRUCTURE TREATMENT. HOWEVER, THIS COMPANY WARRANTIES THE ENTIRE STRUCTURE FOR THREE (3) FULL YEARS FROM THE DATE OF COMPLETION FOR DRYWOOD TERMITE AND SUBTERRANEAN TERMITE INFESTATIONS, WHEN A PRIMARY/SECONDARY TREATMENT IS COMPLETED.

IF SECONDARY/SUBSTANDARD RECOMMENDATIONS ARE LISTED ON THIS REPORT THEY WERE RECOMMENDED AT OWNER'S OR AGENT'S REQUEST. THESE SECONDARY RECOMMENDATIONS ARE CONSIDERED TO BE BELOW STANDARD. IN ADDITION HI TECH TERMITE CONTROL ALSO RECOMMENDS A STANDARD RECOMMENDATION LISTED AS PRIMARY RECOMMENDATIONS ON THIS REPORT.

SPOT TREATMENT WARRANTIES COVERS AREAS TREATED ONLY FOR (1) ONE YEAR FROM THE DATE OF COMPLETION. EXTENDED WARRANTY AGREEMENT ARE NOT AVAILABLE ON SPOT TREATMENTS.

THIS INSPECTION REPORT LISTS FINDINGS AND RECOMMENDATIONS FOR THE STRUCTURE AS INDICATED BY THE ITEM NUMBERS ON THE DIAGRAM

THIS COMPANY DOES NOT ASSUME ANY RESPONSIBILITY FOR ANY DAMAGE CAUSED WHEN DRILLING INTO SLAB FOUNDATIONS, SUCH AS DAMAGE TO HIDDEN PIPE(S), ELECTRICAL CONDUIT(S), OR HEATING DUCT(S), HOWEVER THIS COMPANY DOES USE A METAL DETECTING DEVICE WHEN DRILLING THROUGH SLAB, WHICH WILL SHUT OFF THE DRILL UPON CONTACTING METAL.

THIS COMPANY DOES NOT DO REPAIR ITEMS LISTED FOR LICENSED CONTRACTORS.

THE STATE OF CALIFORNIA AFFIRMS THAT ANY TREATMENT OTHER THAN A PRIMARY TREATMENT IS CONSIDERED SUBSTANDARD.

THIS COMPANY WILL REINSPECT REPAIRS DONE BY OTHERS WITHIN FOUR MONTHS OF THE ORIGINAL INSPECTION. A CHARGE, IF ANY, CAN BE NO GREATER THAN THE ORIGINAL INSPECTION FEE FOR EACH REINSPECTION. THE REINSPECTION MUST BE DONE WITHIN TEN (10) WORKING DAYS OF REQUEST. THE REINSPECTION IS A VISUAL INSPECTION AND IF INSPECTION OF CONCEALED AREAS IS DESIRED, INSPECTION OF WORK IN PROGRESS WILL BE NECESSARY. ANY GUARANTEES MUST BE RECEIVED FROM PARTIES PERFORMING REPAIRS.

Hi Tech Termite Control of the Bay Area

Page 3 of 6 of Standard Inspection Report

1035 NEWHALL ST. SAN JOSE CA 95128
 Address of Property Inspected City State Zip

Stamp No. 5/1/2006 Date of Inspection 14796 Co. Report No. Escrow No.

THIS ORIGINAL INSPECTION REPORT IS THE REPORT OF THE FIRST INSPECTION CONDUCTED BY THIS COMPANY ON THE STRUCTURE AT THE REQUEST OF OWNER OR AGENT. THIS ORIGINAL REPORT CAN BE EITHER A COMPLETE REPORT OR A LIMITED REPORT. A COMPLETE REPORT IS THE REPORT OF AN INSPECTION OF ALL VISIBLE AND ACCESSIBLE PORTIONS OF A STRUCTURE. A LIMITED REPORT IS THE REPORT ON ONLY PART OF A STRUCTURE.

SECTION I CONTAINS ITEMS WHERE THERE IS EVIDENCE OF ACTIVE INFESTATION, INFESTION OR CONDITIONS THAT HAVE RESULTED IN OR FROM INFESTATION OR INFESTION.

SECTION II ITEMS ARE CONDITIONS DEEMED LIKELY TO LEAD TO INFESTATION OR INFESTION BUT WHERE NO VISIBLE EVIDENCE OF SUCH WAS FOUND.

FURTHER INSPECTION ITEMS ARE DEFINED AS RECOMMENDATIONS TO INSPECT AREA(S) WHICH DURING THE ORIGINAL INSPECTION DID NOT ALLOW THE INSPECTOR ACCESS TO COMPLETE HIS INSPECTION AND CANNOT BE DEFINED AS SECTION I OR II.

1. SUBSTRUCTURE AREA:

01A - FINDING-CELLULOSE DEBRIS NOTED AT SUBAREA AS INDICATED BY 1A ON THE DIAGRAM.

RECOMMENDATION: OWNER TO REMOVE CELLULOSE DEBRIS FROM PROPERTY.
 SECTION 2

01B - FINDING-SURFACE FUNGUS NOTED AT SUBFLOOR PLUMBING ACCESS AS INDICATED BY 1B ON THE DIAGRAM.

RECOMMENDATION: OWNER TO CONTACT A LICENSED CONTRACTOR TO MAKE NECESSARY REPAIRS.
 SECTION 1

01C - FINDING-EXCESSIVE MOISTURE NOTED AT FOUNDATIONS AS INDICATED BY 1C ON THE DIAGRAM.

RECOMMENDATION: OWNER TO CONTACT A LICENSED CONTRACTOR TO MAKE NECESSARY REPAIRS.
 SECTION 2

8. GARAGES:

08A - FINDING-INACCESSIBLE AREAS NOTED AT GARAGE WALLS DUE TO STORAGE AS INDICATED BY 8A ON THE DIAGRAM.

RECOMMENDATION-HI TECH TERMITE CONTROL OF THE BAY AREA RECOMMENDS FURTHER INSPECTION.
 SECTION 2

08B - FINDING-EVIDENCE OF DRYWOOD TERMITE INFESTATION WHICH APPEARS TO BE LEADING INTO WALL VOID(S) NOTED AT GARAGE BOXED EAVE AS INDICATED BY 8B ON THE DIAGRAM.

RECOMMENDATION-PRIMARY: VACATE PREMISES AND SEAL STRUCTURE. FUMIGATE WITH A LETHAL GAS (SULFURYL FLUORIDE). REMOVE THE SEALS AND AIR OUT BUILDING. MAKE READY FOR OCCUPANCY. COVER AND/OR REMOVE EVIDENCE. AREA MUST BE VACATED AT TIME OF APPLICATION.

SECONDARY/SUB-STANDARD: TREAT THE ENTIRE ACCESSIBLE INFESTED AREA WITH TERMIDOR (FIPRONIL) BY INJECTION INTO THE TERMITE COLONY AND/OR TIM-BOR (DISODIUM OCTOBORATE) BY APPLYING AS A WET SPRAY TO THE TERMITE INFESTED WOOD. DRILL A 1/2" HOLE LEADING INTO WALL VOID(S). INSERT A FIBER OPTIC SCOPE TO DETERMINE IF THE INFESTATION LEADS INTO WALL VOID FRAMING. TREAT THE WALL VOID FRAMING INFESTATION WITH MICROWAVES AND/OR BORATE FOAM INJECTION. COVER AND/OR REMOVE EVIDENCE. STRUCTURE MUST BE VACATED AT TIME OF APPLICATION. HI TECH TERMITE CONTROL OF THE BAY AREA WILL PATCH HOLES (PAINTING NOT INCLUDED).
 SECTION 1

08C - FINDING-DRYWOOD TERMITE DAMAGE NOTED AT GARAGE BOXED EAVE AS INDICATED BY 8C ON THE DIAGRAM.

Hi Tech Termite Control of the Bay Area

Page 4 of 6 of Standard Inspection Report

1035 NEWHALL ST. SAN JOSE CA 95128
Address of Property Inspected City State Zip

Stamp No. 5/1/2006 14796
Date of Inspection Co. Report No. Escrow No.

08C - FINDING-DRYWOOD TERMITE DAMAGE NOTED AT GARAGE BOXED EAVE AS INDICATED BY 8C ON THE DIAGRAM.

RECOMMENDATION: OWNER TO CONTACT A LICENSED CONTRACTOR TO MAKE NECESSARY REPAIRS.
SECTION 1

08D - FINDING-MOISTURE STAIN NOTED AT WALL ABOVE GARAGE SIDE DOOR AS INDICATED BY 8D ON THE DIAGRAM.

RECOMMENDATION: OWNER TO CONTACT A LICENSED CONTRACTOR TO MAKE NECESSARY REPAIRS.
SECTION 2

08E - FINDING-INACCESSIBLE AREAS NOTED AT DECK ELEVATED PORCH DUE TO SLEEPER CONSTRUCTION AS INDICATED BY 8E ON THE DIAGRAM.

RECOMMENDATION-HI TECH TERMITE CONTROL OF THE BAY AREA RECOMMENDS FURTHER INSPECTION.
SECTION 2

08F - FINDING-FUNGUS AND DRY ROT NOTED AT GARAGE SIDING AS INDICATED BY 8F ON THE DIAGRAM.

RECOMMENDATION: OWNER TO CONTACT A LICENSED CONTRACTOR TO MAKE NECESSARY REPAIRS.
SECTION 1

08G - FINDING-EVIDENCE OF SUBTERRANEAN TERMITES NOTED AT GARAGE SIDING AS INDICATED BY 8G ON THE DIAGRAM.

RECOMMENDATION: DRILL THROUGH SLAB AND PRESSURE TREAT WITH STATE REGISTERED CHEMICAL PRELUDE (PERMETHRIN) FOR THE CONTROL OF SUBTERRANEAN TERMITES. REMOVE ALL ACCESSIBLE TUBING/SEAL HOLES. HI TECH TERMITE CONTROL OF THE BAY AREA WILL NOT BE RESPONSIBLE FOR ANY POSSIBLE DAMAGE TO HIDDEN PIPES, CONDUITS, OR DUCTS IN THE COURSE OF WORK. AREA MUST BE VACATED AT TIME OF APPLICATION. HI TECH TERMITE CONTROL OF THE BAY AREA WILL PATCH HOLES (PAINTING NOT INCLUDED).
SECTION 1

08H - FINDING-SUBTERRANEAN TERMITE DAMAGE NOTED AT GARAGE SIDING AS INDICATED BY 8H ON THE DIAGRAM.

RECOMMENDATION: OWNER TO CONTACT A LICENSED CONTRACTOR TO MAKE NECESSARY REPAIRS.
SECTION 1

08I - FINDING-FUNGUS AND DRY ROT NOTED AT GARAGE SIDE DOOR PORCH STEP AS INDICATED BY 8I ON THE DIAGRAM.

RECOMMENDATION: OWNER TO CONTACT A LICENSED CONTRACTOR TO MAKE NECESSARY REPAIRS.
SECTION 1

10. OTHER - INTERIOR:

10A - FINDING-INACCESSIBLE AREAS NOTED AT DINING ROOM DUE TO DOOR WAS PAINTED SHUT AS INDICATED BY 10A ON THE DIAGRAM.

RECOMMENDATION-HI TECH TERMITE CONTROL OF THE BAY AREA RECOMMENDS FURTHER INSPECTION.
SECTION 2

11. OTHER - EXTERIOR:

11A - FINDING-INACCESSIBLE AREAS NOTED AT PORTIONS OF EXTERIOR DUE TO ZERO PROPERTY LINE AS INDICATED BY 11A ON THE DIAGRAM.

RECOMMENDATION-HI TECH TERMITE CONTROL OF THE BAY AREA RECOMMENDS FURTHER INSPECTION.

Hi Tech Termite Control of the Bay Area

Page 5 of 6 of Standard Inspection Report

1035 NEWHALL ST. SAN JOSE CA 95128
Address of Property Inspected City State Zip

Stamp No. 5/1/2006 Date of Inspection 14796 Co. Report No. Escrow No.

RECOMMENDATION-HI TECH TERMITE CONTROL OF THE BAY AREA RECOMMENDS FURTHER INSPECTION.
SECTION 2

11B - FINDING-FUNGUS AND DRY ROT NOTED AT BOXED EAVE AS INDICATED BY 11B ON THE DIAGRAM.

RECOMMENDATION: OWNER TO CONTACT A LICENSED CONTRACTOR TO MAKE NECESSARY REPAIRS.
SECTION 1

"Thank you for selecting our company to perform a structural pest control inspection on your property. Our inspectors have determined that your property will benefit from the safe application of a chemical commonly used for structural pest control. In accordance with the laws and regulations of the State of California, we are required to provide you and your occupants with the following information prior to any application of chemicals to such property. Please take a few moments to read and become familiar with the content.

State Law requires that you be given the following information:

"CAUTION - PESTICIDES ARE TOXIC CHEMICALS. Structural Pest Control Operators are licensed and regulated by the Structural Pest control Board, and apply pesticides which are registered and approved for use by the California Department of Food and Agriculture and the United States Environmental Protection Agency. Registration is granted when the state finds that based on scientific evidence, there are no appreciable risks weighted by the benefits. The degree of risk depends on the degree of exposure, so exposure should be minimized."

"If within 24 hours following application, you experience symptoms similar to common seasonal illness comparable to the flu, contact your physician or poison control center and your pest control operator immediately."

For further information contact any of the following:
Hi Tech Termite Control of the Bay Area-1-888-322-8889
County Health Department-510-267-8000
California Poison Control Center -1-800-222-1222
County Agricultural Commissioner -510-670-5232
Structural Pest Control Board -916-561-8700

COUNTY HEALTH DEPARTMENT:

- ALAMEDA COUNTY-510-267-8000
- CONTRA COSTA COUNTY-925-313-6710
- MONTEREY COUNTY-831-847-7650
- SACRAMENTO COUNTY-916-875-5877
- SAN BENITO COUNTY-831-636-4035
- SAN FRANCISCO COUNTY-415-252-3800
- SAN MATEO COUNTY-650-573-2757
- SANTA CLARA COUNTY-408-885-4214
- SANTA CRUZ COUNTY-831-454-4100
- MARIN COUNTY-415-499-6907

COUNTY AGRICULTURE COMMISSIONER:

- ALAMEDA COUNTY-510-670-5232
- CONTRA COSTA COUNTY-925-646-5250
- MONTEREY COUNTY-831-759-7325
- SACRAMENTO COUNTY-916-875-6603
- SAN BENITO COUNTY-831-637-5344
- SAN FRANCISCO COUNTY-415-285-5010
- SAN MATEO COUNTY-650-363-4700
- SANTA CLARA COUNTY-408-299-2172
- SANTA CRUZ COUNTY-831-763-8080
- MARIN COUNTY-415-899-8601

Hi Tech Termite Control of the Bay Area

Page 6 of 6 of Standard Inspection Report

1035 NEWHALL ST. SAN JOSE CA 95128
 Address of Property Inspected City State Zip

Stamp No. Date of Inspection 5/1/2006 Co. Report No. 14796 Escrow No.

FOR EMERGENCY DIAL 911

- | | | | |
|----------------------------------|---------|------------------------------------|---------|
| 1 () Prelude Permethrin | _____ % | 2 () Borid Orthoboric Acid | _____ % |
| 3 () Timbor Disodium Octaborate | _____ % | 4 () Borecare Disodium Octaborate | _____ % |
| 5 () Termitafoam Sodium Lauryl | _____ % | 6 () Vikene Sulfuryl Fluoride | _____ % |
| 7 () Power Plant Orange Oil | _____ % | 8 () Permethrin Permethrin | _____ % |
| 9 () Termidor Fipronil | _____ % | 10 () BoridTurbo Orthoboric Acid | _____ % |

THANK YOU FOR CHOOSING HI TECH TERMITE CONTROL OF THE BAY AREA

INVOICE / STATEMENT

Hi Tech Termite Control of the Bay Area

21063 Cabot Blvd. #6
Hayward CA 94545

Tel 888-322-8889 Fax 510-661-4218 Alt 510-661-4210

Date: 5/1/2006
Report Number: 14796
Invoice Number: 14796
Escrow Number:

Property Inspected: 1035 NEWHALL ST.
SAN JOSE, CA 95128

Bill To: CHRISTOPHER HARTMAN

Inspection Amount: \$150.00
Contract: \$0.00
Labor/Materials: \$0.00
Miscellaneous: \$0.00
Interest: \$0.00

Invoice Total: \$150.00

Payments: \$150.00
Additional Charge: \$0.00

Total Due: \$0.00

Description of Service

TERMITE INSPECTION FOR 1035 NEWHALL ST. SAN JOSE, CA 95128.

RETAIN THIS COPY FOR YOUR RECORDS

THANK YOU FOR YOUR BUSINESS

CUT HERE

CUT HERE

CUT HERE

INVOICE / STATEMENT

Hi Tech Termite Control of the Bay Area

21063 Cabot Blvd. #6
Hayward CA 94545

Tel 888-322-8889 Fax 510-661-4218 Alt 510-661-4210

Date: 5/1/2006
Report Number: 14796
Invoice Number: 14796
Escrow Number:

Property Inspected: 1035 NEWHALL ST.
SAN JOSE, CA 95128

Bill To: CHRISTOPHER HARTMAN

Inspection Amount: \$150.00
Contract: \$0.00
Labor/Materials: \$0.00
Miscellaneous: \$0.00
Interest: \$0.00

Invoice Total: \$150.00

Payments: \$150.00
Additional Charge: \$0.00

Total Due: \$0.00

Description of Service

TERMITE INSPECTION FOR 1035 NEWHALL ST. SAN JOSE, CA 95128.

RETURN THIS COPY WITH REMITTANCE

THANK YOU FOR YOUR BUSINESS



HiTech Termite Control of the Bay Area Inc.

www.hitechtermite.com
21063 Cabot Blvd, Ste. #6 • Hayward, CA 94545
(888) 322-8889 Office • (510) 661-4218 Fax

Bid/Work Agreement & Authorization For Termite Control

CA State Lic. #PR4138

I. AGREEMENT

OWNER/AUTHORIZED AGENT: Christopher Hanrahan DATE: 5/1/06
 PROPERTY ADDRESS: 855 Hanrahan Ct
 CITY: San Jose STATE: CA ZIP: 95128
 INSPECTOR: John P. Williams Jr WORK DATE: _____ TIME: _____

TREATMENTS:

Drywood Termite Cost: 800
 Subterranean Termite Cost: 450
 Preventive Cost: 0
 Other _____ Cost: _____
 Discount: _____
 Total: 1250
 Down Payment: 125
 Balance Due Upon Completion: 1125

DOWN PAYMENT MADE BY: CASH CHECK NO _____
 VISA MASTERCARD DISCOVER

ACCT. NO. _____ EXP. DATE _____

V. TYPE OF TREATMENT

Primary Treatment for Drywood Termite Infestation(s) - Fumigation with lethal gas for the eradication of all drywood termite infestations. This treatment includes a three (3) year full structure warranty against all drywood termite infestations.

Secondary Treatment for Drywood Termite Infestation(s) - Microwave and/or Termidor/borate foam injection for the treatment of all drywood termite infestations, which may extend into wall voids. All accessible drywood termite infestations will be treated with boric acid/termidor injections and/or a spray application of sodium borate oil for the control of drywood termite infestations. This treatment includes a three (3) year full structure warranty against all drywood termite infestations. Fumigation is not included with this treatment.

Primary Treatment for Subterranean Termites - Ppermethrin or Termidor application to the soil where the subterranean termite infestation(s) are located. This will be completed by drilling through the slab or trenching along the foundation walls, for the control of subterranean termite infestations. This treatment includes a three (3) year full structure warranty against all subterranean termite infestation.

Preventative Treatment for Drywood and Subterranean Termite Infestations - This treatment is a spray application of Tim-bor (sodium borate) to all accessible, unpainted wood within the structure (attics, subareas, garages, etc.) This treatment can be completed in conjunction with our primary or secondary treatment at an additional cost. Remove storage from attic and garage for spray application.

Spot Treatment for Drywood Termite Infestation - Borate/Termidor application to accessible infestation (s) for the control of drywood termites. One (1) year warranty for the areas treated only Fumigation is not included with this treatment.

Spot Treatment for Subterranean Termites - Permethrin application to the soil where the subterranean termite infestation(s) are located. This will be completed by drilling through the slab or trenching along the foundation walls for the control of subterranean termite infestation. One (1) year warranty.

Spot Treatment for Subterranean Termites - Termidor application to the soil where the subterranean termite infestation (s) are located. This will be completed by drilling through the slab or trenching along the foundation walls, for the control of subterranean termite infestation.

II. WARRANTY

THREE YEAR WARRANTY/ PRIMARY TREATMENT FOR DRYWOOD TERMITES - This full structure warranty covers the treatment of drywood termites on the above-mentioned property for three (3) full years from the date of completion of original work. Any new or recurring drywood termite infestations noted during the warranty period will be treated by this company at no additional cost to the customer. This warranty is in effect only if full payment has been made on services rendered. There will be a \$50.00 fee for all inspections for escrow while the warranty is in effect.

THREE YEAR WARRANTY / SECONDARY TREATMENT FOR DRYWOOD TERMITES - Same as above. Fumigation is not covered by this warranty.

THREE YEAR WARRANTY / SUBTERRANEAN TERMITES - This full structure warranty covers the treatment of subterranean termite infestations on the above mentioned property for three (3) full years from the date of completion of original work. Any new or recurring subterranean termite infestations noted during the warranty period will be treated by Hi Tech Termite Control at no additional cost to the customer. This warranty is in effect only if full payment has been made for services rendered. There will be a \$50.00 fee for all escrow inspections while the warranty is in effect.

ONE YEAR WARRANTY/SPOT TREATMENT

For: Drywood Termites only Subterranean Termites only
 Preventative Treatment Other: _____

On: Area(s) Only

VI TERMS

Cash upon completion. Financing with VISA, Master Card or Discover is available. A ten percent deposit shall be required at the time job is ordered. VISA or Master Card is accepted same as cash. If job is postponed and HI TECH TERMITE CONTROL OF THE BAY AREA, INC is notified less than forty-eight hours prior to postponement, an additional ninety-five dollars will be added to the estimate. A cancellation fee of ten percent will be charged if job is canceled. Multi-Unit Complexes Note: All units must be accessible on work date scheduled. HI TECH TERMITE CONTROL OF THE BAY AREA, INC. is not responsible for inaccessible units and the balance will be due upon completion of accessible units. Inaccessible units will be treated after balance is paid in full.

THIS QUOTE PRICE IS VALID FOR NINETY DAYS.

III. EXTENDED WARRANTY

An extended warranty is available on this property if original warranty from this firm has not expired. The extended warranty shall commence after the primary or secondary warranty expires. **The extended warranty is available for renewal on a yearly basis and is transferable upon sale or transfer of the property.**

Yearly cost of extended warranty: \$ 275.00 / year

This price is guaranteed for two years.

An extended warranty is not offered with the agreed treatment.

HI TECH TERMITE CONTROL OF THE BAY AREA, INC. is hereby authorized to treat my property for the control of the following wood destroying insects:

Owner or Authorized Agent's Agreement _____ Date _____

All work shall be done in a workmanship-like manner in accordance with all applicable codes

IV. EXCLUSIONS & DISCLAIMERS

Our alternative system in and of itself is not a whole structure treatment. This bid does not include the repair, correction or treatment of fungus, dry rot, damage caused by water or plumbing leaks, exterior fences, structural or correctional repairs. These items may be noted on the inspection report, however they must be corrected by a licensed contractor of your choice. HI TECH TERMITE CONTROL OF THE BAY AREA, INC. will not assume any liability for any slab injection or any damage caused to any auxiliary connection that is embedded in concrete of any slab or foundation construction. The use of schematics and/or drawings does not imply or assume responsibility on the part of HI TECH TERMITE CONTROL OF THE BAY AREA, INC. Said documents are for information purposes only. **NOTE:** if your property requires drilling through concrete slabs, this firm will not be responsible for possible damage to hidden pipes, conduits, floor coverings and/or ducts during the course of work. Due to age, condition and base board construction, HI TECH TERMITE CONTROL OF THE BAY AREA, INC. will re-install carpeting and/or flooring to the best intent possible. Should you wish to have carpet re-stretched, new tack board replaced or installed, or carpet reinstated it shall be at the direction and expense of the property owner. HI TECH TERMITE CONTROL OF THE BAY AREA, INC. shall not be responsible for the reinstallation or replacement of any carpet, flooring material, or flooring construction.

VII NOTICE

The charges for services that HI TECH TERMITE CONTROL OF THE BAY AREA, INC. subcontract to another person or entity may include HI TECH TERMITE CONTROL OF THE BAY AREA, INC. charges for arranging and administering such services that are in addition to the direct costs associated with paying the subcontractor. Company's that may be subcontracted.

Name _____ Phone _____

Address _____

STATE LAW REQUIRES THAT YOU BE GIVEN THE FOLLOWING INFORMATION.

CAUTION - Pesticides are toxic chemicals. Structural Pest Control Operators are licensed and regulated by the Structural Pest Control Board and apply pesticides which are registered and approved for use by the California Department of Food and Agriculture and the United States Environmental Protection Agency. Registration is granted when the State finds that based on existing scientific evidence there are no appreciable risks if proper use conditions are followed or that the risks are outweighed by the benefits. The degree of risk depends upon the degree of exposure. So exposure should be minimized. If within 24 hours after application you experience symptoms similar to common household air air contaminants in the air, contact your physician or California Poison Control System Center (800-278-4789) and HI TECH TERMITE CONTROL OF THE BAY AREA, INC. (888-322-6680).

For further information, contact one of the following for health questions: County Health Department, Alameda (510-269-2744), Contra Costa (925-313-4719), Los Angeles (213-290-8055), Marin (415-488-6907), Monterey (831-847-7501), Orange Co. (714-834-2165), San Diego (619-388-3223), San Mateo (650-673-2757), Santa Barbara (805-981-4200), Santa Clara (408-885-4214), Santa Cruz (831-454-1000), Sonoma (707-569-4820), Ventura (805-452-0219), San Francisco (415-262-3900).

For application information: County Agricultural Commissioner, Alameda (510-670-8232).

I understand, and agree, that any of the following chemicals may be used, if found necessary by the State Licensed Inspector, in conjunction with a microwave treatment:

<input checked="" type="checkbox"/> TIMBOR (Disodium Octaborate Tetrahydrate)	<input checked="" type="checkbox"/> BORACARE (Disodium Octaborate Tetrahydrate)
<input checked="" type="checkbox"/> TERMITACIAM (Sodium Lauryl)	<input checked="" type="checkbox"/> PELLUD (Permethrin)
<input checked="" type="checkbox"/> BORIC (Orthoboric Acid)	<input checked="" type="checkbox"/> VIKANE (Borax/Fluoride)
<input checked="" type="checkbox"/> OTHER _____	<input checked="" type="checkbox"/> TERMIDOR (Fipronil)