

# WOOD DESTROYING PESTS AND ORGANISMS INSPECTION REPORT

Building No. 540A	Street 9TH AVE	City MENLO PARK	Zip 94025	Date of Inspection 6/11/09	Number of Pages 6
----------------------	-------------------	--------------------	--------------	-------------------------------	----------------------

**Hi Tech Termite Control of the Bay Area**  
**21063 Cabot Blvd. #6**  
**Hayward CA 94545**  
 Tel 888-322-8889 Fax 510-661-4218 Alt 510-661-4210

Report # : 20061  
 Registration # : FR 4138  
 Escrow # :  
 CORRECTED REPORT

Ordered by: KATRINA EDWARDS 3101 MIDDLEFIELD RD #2 PALO ALTO CA 94306	Property Owner and/or Party of Interest: UNKNOWN 540A 9TH AVE MENLO PARK CA 94025  KATRINA EDWARDS 3101 MIDDLEFIELD RD #2 PALO ALTO CA 94306	Report sent to: KATRINA EDWARDS 3101 MIDDLEFIELD RD #2 PALO ALTO CA 94306
--	---	--

COMPLETE REPORT    
 LIMITED REPORT    
 SUPPLEMENTAL REPORT    
 REINSPECTION REPORT

GENERAL DESCRIPTION: 2 STORY WOODSIDING & FRAME RESIDENCE FURNISHED & OCCUPIED WITH METAL ROOF, ATTACHED GARAGE & UNPRV UNDER AREA.	Inspection Tag Posted: GARAGE  Other Tags Posted:
---	--

An inspection has been made of the structure(s) shown on the diagram in accordance with the Structural Pest Control Act. Detached porches, detached steps, detached decks and any other structures not on the diagram were not inspected.

Subterranean Termites    
 Drywood Termites    
 Fungus / Dryrot    
 Other Findings    
 Further Inspection

If any of the above boxes are checked, it indicates that there were visible problems in accessible areas. Read the report for details on checked

Diagram Not To Scale

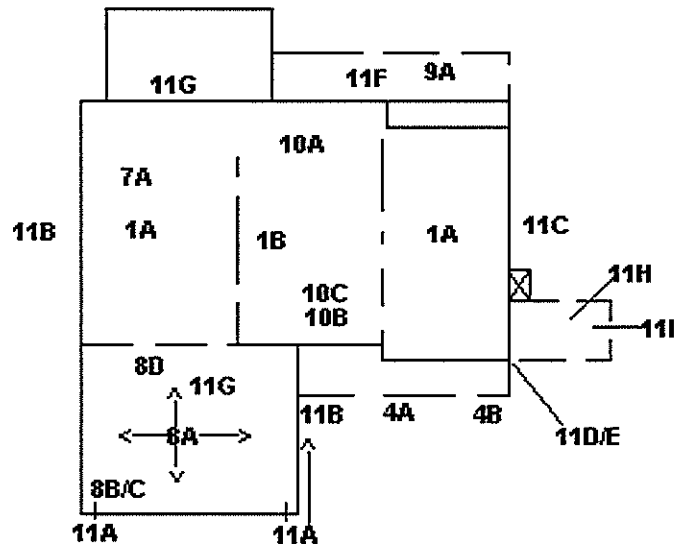

Front

Inspected By: TERRENCE ROBINSON State License No. FR 32783 Signature: \_\_\_\_\_

You are entitled to obtain copies of all reports and completion notices on this property reported to the Structural Pest Control Board during the preceding two years. To obtain copies contact: Structural Pest Control Board, 2005 Evergreen Street, Suite 1500, Sacramento, California, 95815-3831.  
 NOTE: Questions or problems concerning the above report should be directed to the manager of the company. Unresolved questions or problems with services performed may be directed to the Structural Pest Control Board at (916) 561-8708, (800) 737-8188 or [www.pestboard.ca.gov](http://www.pestboard.ca.gov). 43M-41 (Rev. 10/01)

# Hi Tech Termite Control of the Bay Area

Page 2 of inspection report

540A	9TH AVE	MENLO PARK	CA	94025
Address of Property Inspected		City	State	Zip
	6/11/09	20061		
Stamp No.	Date of Inspection	Co. Report No.	Escrow No.	

**WHAT IS A WOOD DESTROYING PEST & ORGANISM INSPECTION REPORT? READ THIS DOCUMENT. IT EXPLAINS THE SCOPE AND LIMITATIONS OF A STRUCTURAL PEST CONTROL INSPECTION AND A WOOD DESTROYING PEST & ORGANISM INSPECTION REPORT.**

A Wood Destroying Pest & Organism Inspection Report contains findings as to the presence or absence of evidence of wood destroying pests and organisms in visible and accessible areas and contains recommendations for correcting any infestations or infections found. The contents of Wood Destroying Pest & Organism Inspection Reports are governed by the Structural Pest Control Act and regulations.

Some structures do not comply with building code requirements or may have structural, plumbing, electrical, mechanical, heating, air conditioning or other defects that do not pertain to wood destroying organisms. A Wood Destroying Pest & Organism Inspection Report does not contain information on such defects, if any, as they are not within the scope of the licenses of either this company, or it's employees.

**The exterior Surface of the roof was not inspected. If you want the water tightness of the roof determined, you should contact a roofing contractor who is licensed by the Contractor's State License Board.**

This company does not certify or guarantee against any leakage, such as (but not limited to) plumbing, appliances, walls, doors, windows, any type of seepage, roof or deck coverings. This company renders no guarantee, whatsoever, against any infection, infestation or any other adverse condition which may exist in such areas or may become visibly evident in such area after this date. Upon request, further inspection of these areas would be performed at an additional charge.

All pesticides and fungicides must be applied by a state certified applicator (sec. 8555 Business and Professions Code Division 3) and in accordance with the manufacturer's label requirements.

**NOTICE: Reports on this structure prepared by various registered companies should list the same findings (i.e. termite infestations, termite damage, fungus damage, etc.). However, recommendations to correct these findings may vary from company to company. You have a right to seek a second opinion from another company.**

**This Wood Destroying Pest & Organisms Report DOES NOT INCLUDE MOLD or any mold like conditions. No reference will be made to mold or mold-like conditions. Mold is not a Wood Destroying Organism and is outside the scope of this report as defined by the Structural Pest Control Act. If you wish your property to be inspected for mold or mold like conditions, please contact the appropriate mold professional.**

THERE ARE CERTAIN AREAS OF A STRUCTURE WHICH ARE CONSIDERED IMPRACTICAL FOR INSPECTION: THE INTERIOR OF HOLLOW WALLS, BETWEEN FLOORS, UNDER DECKS THAT HAVE A CLEARANCE OF LESS THAN 18 INCHES OR THAT ARE HEAVILY INSULATED, FOOTINGS UNDER COLUMNS OR ARCH ABUTMENTS, RAT PROOF SUB AREAS, INSULATED SUB FLOORING, AREA UNDER FLOOR COVERINGS, UNDER OR BEHIND HOME FURNISHINGS, INSIDE BOXED EAVES, INSIDE WOOD PORCHES, SOFFITS. THESE AREAS ARE CONSIDERED TO BE INACCESSIBLE AT THE TIME OF INSPECTION.

IF THIS COMPANY FINDS EVIDENCE OF DRYWOOD TERMITES LEADING INTO WALL VOID FRAMING, THE WALL VOID WILL BE EXAMINED BY THE USE OF A FIBER OPTIC SCOPE AND FURTHER RECOMMENDATIONS WILL BE MADE FOR TREATING THOSE AREAS WITH MICROWAVES, FOAM INJECTION, OR BY FUMIGATION.

THIS COMPANY CANNOT BE RESPONSIBLE FOR ANY LEAKS OR OTHER ADVERSE CONDITIONS WHICH MAY DEVELOP IN INACCESSIBLE AREAS AND BECOME VISIBLY EVIDENT AFTER THE DATE OF INSPECTION THIS COMPANY, HOWEVER, DOES WARRANTY THE ENTIRE STRUCTURE FOR THREE (3) FULL YEARS FROM THE DATE OF COMPLETION FOR ALL DRYWOOD TERMITE AND SUBTERRANEAN TERMITE INFESTATIONS UNDER OUR PRIMARY TREATMENT.

AT OWNERS REQUEST SECONDARY/SUBSTANDARD RECOMMENDATIONS CAN BE MADE FOR THE TREATMENT OF THIS STRUCTURE.

SECOND STORY STALL SHOWER STALLS ARE INSPECTED, BUT THEY ARE NOT TESTED, UNLESS THERE IS EVIDENCE OF LEAKS IN THE CEILING BELOW.

## ADDITIONAL NOTES OR REMARKS:

THE MICROWAVE/BORATE INJECTION PROCESS IS NOT A FULL STRUCTURE TREATMENT. HOWEVER, THIS COMPANY WARRANTIES THE ENTIRE STRUCTURE FOR THREE (3) FULL YEARS FROM THE DATE OF COMPLETION FOR DRYWOOD TERMITE AND SUBTERRANEAN TERMITE INFESTATIONS, WHEN A PRIMARY/SECONDARY TREATMENT IS COMPLETED.

IF SECONDARY/SUBSTANDARD RECOMMENDATIONS ARE LISTED ON THIS REPORT THEY WERE RECOMMENDED AT OWNER'S OR AGENT'S REQUEST. THESE SECONDARY RECOMMENDATIONS ARE CONSIDERED TO BE BELOW STANDARD. IN ADDITION HI TECH TERMITE CONTROL ALSO RECOMMENDS A STANDARD RECOMMENDATION LISTED AS PRIMARY RECOMMENDATIONS ON THIS REPORT.

SPOT TREATMENT WARRANTIES COVERS AREAS TREATED ONLY FOR (1) ONE YEAR FROM THE DATE OF COMPLETION. EXTENDED WARRANTY AGREEMENT ARE NOT AVAILABLE ON SPOT TREATMENTS.

THIS INSPECTION REPORT LISTS FINDINGS AND RECOMMENDATIONS FOR THE STRUCTURE AS INDICATED BY THE ITEM NUMBERS ON THE DIAGRAM.

THIS COMPANY DOES NOT ASSUME ANY RESPONSIBILITY FOR ANY DAMAGE CAUSED WHEN DRILLING INTO SLAB FOUNDATIONS, SUCH AS DAMAGE TO HIDDEN PIPE(S), ELECTRICAL CONDUIT(S), OR HEATING DUCT(S), HOWEVER THIS COMPANY DOES USE A METAL DETECTING DEVICE WHEN DRILLING THROUGH SLAB, WHICH WILL SHUT OFF THE DRILL UPON CONTACTING METAL.

THIS COMPANY DOES NOT DO REPAIR ITEMS LISTED FOR LICENSED CONTRACTORS.

THE STATE OF CALIFORNIA AFFIRMS THAT ANY TREATMENT OTHER THAN A PRIMARY TREATMENT IS CONSIDERED SUBSTANDARD.

THIS COMPANY WILL REINSPECT REPAIRS DONE BY OTHERS WITHIN FOUR MONTHS OF THE ORIGINAL INSPECTION. A CHARGE, IF ANY, CAN BE NO GREATER THAN THE ORIGINAL INSPECTION FEE FOR EACH REINSPECTION. THE REINSPECTION MUST BE DONE WITHIN TEN (10) WORKING DAYS OF REQUEST. THE REINSPECTION IS A VISUAL INSPECTION AND IF INSPECTION OF CONCEALED AREAS IS DESIRED, INSPECTION OF WORK IN PROGRESS WILL BE NECESSARY. ANY GUARANTEES MUST BE RECEIVED FROM PARTIES PERFORMING REPAIRS.

# Hi Tech Termite Control of the Bay Area

Page 3 of 6 of Standard Inspection Report

540A	9TH AVE	MENLO PARK	CA	94025
Address of Property Inspected		City	State	Zip
Stamp No.	6/11/09	20061	Escrow No.	
	Date of Inspection	Co. Report No.		

THIS ORIGINAL INSPECTION REPORT IS THE REPORT OF THE FIRST INSPECTION CONDUCTED BY THIS COMPANY ON THE STRUCTURE AT THE REQUEST OF OWNER OR AGENT. THIS ORIGINAL REPORT CAN BE EITHER A COMPLETE OR LIMITED REPORT. A COMPLETE REPORT IS THE REPORT OF AN INSPECTION OF ALL VISIBLE AND ACCESSIBLE PORTIONS OF A STRUCTURE. A LIMITED REPORT IS THE REPORT ON ONLY PART OF A STRUCTURE.

SECTION I CONTAINS ITEMS WHERE THERE IS EVIDENCE OF ACTIVE INFESTATION, INFECTION OR CONDITIONS THAT HAVE RESULTED IN OR FROM INFESTATION OR INFECTION.

SECTION II ITEMS ARE CONDITIONS DEEMED LIKELY TO LEAD TO INFESTATION OR INFECTION BUT WHERE NO VISIBLE EVIDENCE OF SUCH WAS FOUND.

FURTHER INSPECTION ITEMS ARE DEFINED AS RECOMMENDATIONS TO INSPECT AREA(S) WHICH DURING THE ORIGINAL INSPECTION DID NOT ALLOW THE INSPECTOR ACCESS TO COMPLETE HIS INSPECTION AND CANNOT BE DEFINED AS SECTION I OR II.

## 1. SUBSTRUCTURE AREA:

01A - FINDING-INACCESSIBLE AREAS NOTED AT SUB AREA DUE TO HEATING DUCT BLOCKING ENTRY AS INDICATED BY 1A ON THE DIAGRAM.

RECOMMENDATION: HI TECH TERMITE CONTROL OF THE BAY AREA RECOMMENDS FURTHER INSPECTION. INFORMATIONAL ITEM

01B - FINDING-SURFACE FUNGUS NOTED AT SUB FRAME AS INDICATED BY 1B ON THE DIAGRAM.

RECOMMENDATION: SCRAPE SURFACE FUNGUS WITH STEEL WOOL BRUSH AND TREAT SURFACE FUNGUS DAMAGED WOOD WITH STATE REGISTERED FUNGICIDE TIM-BOR FOR THE CONTROL OF SURFACE FUNGUS. PRIME AREA FOR PAINTING. IF DAMAGE EXTENDS INTO INACCESSIBLE AREA(S) HI TECH TERMITE CONTROL OF THE BAY AREA WITH SUBMIT A SUPPLEMENTAL REPORT AND BID IF NECESSARY.  
SECTION 1

## 4. PORCHES - STEPS:

04A - FINDING-EXCESSIVE MOISTURE NOTED AT CRACK IN POST PAD AS INDICATED BY 4A ON THE DIAGRAM.

RECOMMENDATION: OWNER TO CONTACT A LICENSED CONTRACTOR TO MAKE NECESSARY REPAIRS.  
SECTION 2

04B - FINDING-INACCESSIBLE AREAS NOTED AT SUPPORT POST DUE TO FOLIAGE AS INDICATED BY 4B ON THE DIAGRAM.

RECOMMENDATION: HI TECH TERMITE CONTROL OF THE BAY AREA RECOMMENDS FURTHER INSPECTION. INFORMATIONAL ITEM

## 7. ATTIC SPACES:

07A - FINDING-INACCESSIBLE AREAS NOTED AT ATTIC DUE TO BLOWN IN INSULATION AS INDICATED BY 7A ON THE DIAGRAM.

RECOMMENDATION: HI TECH TERMITE CONTROL OF THE BAY AREA RECOMMENDS FURTHER INSPECTION. INFORMATIONAL ITEM

## 8. GARAGES:

# Hi Tech Termite Control of the Bay Area

Page 4 of 6 of Standard Inspection Report

540A	9TH AVE	MENLO PARK	CA	94025
Address of Property Inspected		City	State	Zip
Stamp No.	6/11/09	20061	Escrow No.	
	Date of Inspection	Co. Report No.		

08A - FINDING-INACCESSIBLE AREAS NOTED AT GARAGE DUE TO STORAGE AS INDICATED BY 8A ON THE DIAGRAM.  
RECOMMENDATION: HI TECH TERMITE CONTROL OF THE BAY AREA RECOMMENDS FURTHER INSPECTION.  
INFORMATIONAL ITEM

08B - FINDING-EVIDENCE OF SUBTERRANEAN TERMITES NOTED AT GARAGE WALL FRAME AS INDICATED BY 8B ON THE DIAGRAM.  
RECOMMENDATION: DRILL THROUGH SLAB AND PRESSURE TREAT WITH STATE REGISTERED CHEMICAL PREMISE 75 (IMIDACLOPRID) FOR THE CONTROL OF SUBTERRANEAN TERMITES. REMOVE ALL ACCESSIBLE TUBING/SEAL HOLES. HI TECH TERMITE CONTROL OF THE BAY AREA WILL NOT BE RESPONSIBLE FOR ANY POSSIBLE DAMAGE TO HIDDEN PIPES, CONDUITS, OR DUCTS IN THE COURSE OF WORK. AREA MUST BE VACATED AT TIME OF APPLICATION. HI TECH TERMITE CONTROL OF THE BAY AREA WILL PATCH HOLES (PAINTING NOT INCLUDED). SECTION 1

08C - FINDING-SUBTERRANEAN TERMITE DAMAGE NOTED AT GARAGE WALL FRAME AS INDICATED BY 8C ON THE DIAGRAM.  
RECOMMENDATION: REMOVE AND REPLACE ACCESSIBLE SUBTERRANEAN TERMITE DAMAGED WOOD AS NECESSARY. PRIME AREA FOR PAINTING. IF DAMAGE EXTENDS INTO INACCESSIBLE AREA(S), HI TECH TERMITE CONTROL OF THE BAY AREA WILL SUBMIT A SUPPLEMENTAL REPORT AND BID IF NECESSARY.  
SECTION 1

08D - FINDING-MOISTURE STAIN NOTED AT GARAGE WALL AS INDICATED BY 8D ON THE DIAGRAM.  
RECOMMENDATION: OWNER TO CONTACT A LICENSED CONTRACTOR TO MAKE NECESSARY REPAIRS.  
SECTION 2

## 9. DECKS - PATIOS:

09A - FINDING-INACCESSIBLE AREAS NOTED AT DECK (NO CLEARANCE) AS INDICATED BY 9A ON THE DIAGRAM.  
RECOMMENDATION: HI TECH TERMITE CONTROL OF THE BAY AREA RECOMMENDS FURTHER INSPECTION.  
INFORMATIONAL ITEM

## 11. OTHER - EXTERIOR:

11A - FINDING-INACCESSIBLE AREAS NOTED AT BASE WALL EXTERIOR DUE TO FOLIAGE AS INDICATED BY 11A ON THE DIAGRAM.  
RECOMMENDATION: HI TECH TERMITE CONTROL OF THE BAY AREA RECOMMENDS FURTHER INSPECTION.  
INFORMATIONAL ITEM

11B - FINDING-MOISTURE DAMAGE NOTED AT WALL AS INDICATED BY 11B ON THE DIAGRAM.  
RECOMMENDATION: OWNER TO CONTACT A LICENSED CONTRACTOR TO MAKE NECESSARY REPAIRS.  
SECTION 2

11C - FINDING-EXCESSIVE MOISTURE NOTED AT WALL (PEELING PAINT) AS INDICATED BY 11C ON THE DIAGRAM.  
RECOMMENDATION: OWNER TO CONTACT A LICENSED CONTRACTOR TO MAKE NECESSARY REPAIRS.  
SECTION 2

11D - FINDING-EVIDENCE OF DRYWOOD TERMITE INFESTATION WHICH APPEARS TO BE LEADING INTO WALL VOID(S) NOTED AT SIDING TRIM AS INDICATED BY 11D ON THE DIAGRAM.  
RECOMMENDATION-PRIMARY: VACATE PREMISES AND SEAL STRUCTURE. FUMIGATE WITH A LETHAL GAS (SULFURYL

# Hi Tech Termite Control of the Bay Area

Page 5 of 6 of Standard Inspection Report

540A	9TH AVE	MENLO PARK	CA	94025
Address of Property Inspected		City	State	Zip
Stamp No.	6/11/09	20061	Escrow No.	
	Date of Inspection	Co. Report No.		

FLUORIDE). REMOVE THE SEALS AND AIR OUT BUILDING. MAKE READY FOR OCCUPANCY. COVER AND/OR REMOVE EVIDENCE. AREA MUST BE VACATED AT TIME OF APPLICATION.

SECONDARY/SUB-STANDARD: TREAT THE ENTIRE ACCESSIBLE INFESTED AREA WITH TERMIDOR (FIPRONIL) BY INJECTION INTO THE TERMITE COLONY AND/OR TIM-BOR (DISODIUM OCTOBORATE) BY APPLYING AS A WET SPRAY TO THE TERMITE INFESTED WOOD. DRILL A 1/2" HOLE LEADING INTO WALL VOID(S). INSERT A FIBER OPTIC SCOPE TO DETERMINE IF THE INFESTATION LEADS INTO WALL VOID FRAMING. TREAT THE WALL VOID FRAMING INFESTATION WITH MICROWAVES AND/OR BORATE FOAM INJECTION. COVER AND/OR REMOVE EVIDENCE. STRUCTURE MUST BE VACATED AT TIME OF APPLICATION. HI TECH TERMITE CONTROL OF THE BAY AREA WILL PATCH HOLES (PAINTING NOT INCLUDED).

SECTION 1

11E - FINDING-DRYWOOD TERMITE DAMAGE NOTED AT SIDING TRIM AS INDICATED BY 11E ON THE DIAGRAM.

RECOMMENDATION: REMOVE AND REPLACE ACCESSIBLE DRYWOOD TERMITE DAMAGED WOOD AS NECESSARY. PRIME AREA FOR PAINTING. IF DAMAGE EXTENDS INTO INACCESSIBLE AREA(S) HI TECH TERMITE CONTROL OF THE BAY AREA WILL SUBMIT A SUPPLEMENTAL REPORT AND BID IF NECESSARY.

SECTION 1

11F - FINDING-EXCESSIVE MOISTURE NOTED AT WATER HEATER CLOSET DOOR AS INDICATED BY 11F ON THE DIAGRAM.

RECOMMENDATION: OWNER TO CONTACT A LICENSED CONTRACTOR TO MAKE NECESSARY REPAIRS.

SECTION 2

11G - FINDING-INACCESSIBLE AREAS NOTED AT 2ND FLOOR EAVES AS INDICATED BY 11G ON THE DIAGRAM.

RECOMMENDATION: HI TECH TERMITE CONTROL OF THE BAY AREA RECOMMENDS FURTHER INSPECTION. INFORMATIONAL ITEM

11H - FINDING-INACCESSIBLE AREAS NOTED AT SIDE SHED DUE TO STORAGE AS INDICATED BY 11H ON THE DIAGRAM.

RECOMMENDATION: HI TECH TERMITE CONTROL OF THE BAY AREA RECOMMENDS FURTHER INSPECTION. INFORMATIONAL ITEM

11I - FINDING-FUNGUS AND DRY ROT NOTED AT SIDE SHED AS INDICATED BY 11I ON THE DIAGRAM.

RECOMMENDATION: DISASSEMBLE & REMOVE SIDE SHED FROM THE PREMISES.

SECTION 1

"Thank you for selecting our company to perform a structural pest control inspection on your property. Our inspectors have determined that your property will benefit from the safe application of a chemical commonly used for structural pest control. In accordance with the laws and regulations of the State of California, we are required to provide you and your occupants with the following information prior to any application of chemicals to such property. Please take a few moments to read and become familiar with the content.

State Law requires that you be given the following information:

""CAUTION - PESTICIDES ARE TOXIC CHEMICALS. Structural Pest Control Operators are licensed and regulated by the Structural Pest control Board, and apply pesticides which are registered and approved for use by the California Department of Food and Agriculture and the United States Environmental Protection Agency. Registration is granted when the state finds that based on scientific evidence, there are no appreciable risks weighted by the benefits. The degree of risk depends on the degree of exposure, so exposure should be minimized.""

""If within 24 hours following application, you experience symptoms similar to common seasonal illness comparable to the flu, contact your physician or poison control center and your pest control operator immediately.""

For further information contact any of the following:

# Hi Tech Termite Control of the Bay Area

Page 6 of 6 of Standard Inspection Report

540A                      9TH AVE    MENLO PARK                      CA                      94025  
Address of Property Inspected    City                      State                      Zip

Stamp No.    6/11/09    20061    Escrow No.

Hi Tech Termite Control of the Bay Area-1-888-322-8889  
County Health Department-510-267-8000  
California Poison Control Center -1-800-222-1222  
County Agricultural Commissioner -510-670-5232  
Structural Pest Control Board -916-561-8700

COUNTY HEALTH DEPARTMENT:

- ALAMEDA COUNTY-510-267-8000
- CONTRA COSTA COUNTY-925-313-6000
- MONTEREY COUNTY-831-647-7650
- SACRAMENTO COUNTY-916-875-5881
- SAN BENITO COUNTY-831-637-5367
- SAN FRANCISCO COUNTY-415-554-2500
- SAN MATEO COUNTY-650-573-2757
- SANTA CLARA COUNTY-408-423-0700
- SANTA CRUZ COUNTY-831-454-4800
- MARIN COUNTY-415-499-3707
- SONOMA COUNTY-707-565-4820

COUNTY AGRICULTURE COMMISSIONER:

- ALAMEDA COUNTY-510-670-5232
- CONTRA COSTA COUNTY-925-646-5250
- MONTEREY COUNTY-831-759-7325
- SACRAMENTO COUNTY-916-875-6603
- SAN BENITO COUNTY-831-637-5344
- SAN FRANCISCO COUNTY-415-252-3830
- SAN MATEO COUNTY-650-363-4700
- SANTA CLARA COUNTY-408-918-4600
- SANTA CRUZ COUNTY-831-763-8080
- MARIN COUNTY-415-499-6700
- SONOMA COUNTY-707-565-2371

FOR EMERGENCY DIAL 911

- |                                 |        |                                   |        |
|---------------------------------|--------|-----------------------------------|--------|
| 1 ( )Prelude Permethrin         | _____% | 2 ( )Borid Orthoboric Acid        | _____% |
| 3 ( )Timbor Disodium Octaborate | _____% | 4 ( )Boracare Disodium Octaborate | _____% |
| 5 ( )Termitafoam Sodium Lauryl  | _____% | 6 ( )Vikane Sulfuryl Fluoride     | _____% |
| 7 ( )Power Plant Orange Oil     | _____% | 8 ( )Permethrin Permethrin        | _____% |
| 9 ( )Termidor Fipronil          | _____% | 10 ( )BoridTurbo Orthoboric Acid  | _____% |
| 11 ( )Premise 75 Imidacloprid   | _____% |                                   |        |

THANK YOU FOR CHOOSING HI TECH TERMITE CONTROL OF THE BAY AREA



**INVOICE / STATEMENT**

**Hi Tech Termite Control of the Bay Area**

21063 Cabot Blvd. #6  
Hayward CA 94545  
Tel 888-322-8889 Fax 510-661-4218 Alt 510-661-4210

Date: 6/11/09  
Report Number: 20061  
Invoice Number: 20061  
Escrow Number:

Property Inspected: 540A 9TH AVE  
MENLO PARK, CA 94025

Bill To: KATRINA EDWARDS  
3101 MIDDLEFIELD RD #2  
PALO ALTO CA 94306

Inspection Amount:	\$150.00
Contract:	\$0.00
Labor/Materials:	\$0.00
Miscellaneous:	\$0.00
Interest:	\$0.00

**Invoice Total:** \$150.00

Payments:	\$0.00
Additional Charge:	\$0.00

**Total Due: \$150.00**

Description of Service

FOR TERMITE INSPECTION @ 540A 9TH AVE, MENLO PARK, CA 94025.

RETAIN THIS COPY FOR YOUR RECORDS

**THANK YOU FOR YOUR BUSINESS**

CUT HERE

CUT HERE

CUT HERE

**INVOICE / STATEMENT**

**Hi Tech Termite Control of the Bay Area**

21063 Cabot Blvd. #6  
Hayward CA 94545  
Tel 888-322-8889 Fax 510-661-4218 Alt 510-661-4210

Date: 6/11/09  
Report Number: 20061  
Invoice Number: 20061  
Escrow Number:

Property Inspected: 540A 9TH AVE  
MENLO PARK, CA 94025

Bill To: KATRINA EDWARDS  
3101 MIDDLEFIELD RD #2  
PALO ALTO CA 94306

Inspection Amount:	\$150.00
Contract:	\$0.00
Labor/Materials:	\$0.00
Miscellaneous:	\$0.00
Interest:	\$0.00

**Invoice Total:** \$150.00

Payments:	\$0.00
Additional Charge:	\$0.00

**Total Due: \$150.00**

Description of Service

FOR TERMITE INSPECTION @ 540A 9TH AVE, MENLO PARK, CA 94025.

RETURN THIS COPY WITH REMITTANCE

**THANK YOU FOR YOUR BUSINESS**



# HiTech Termite Control of the Bay Area Inc.

www.hitechtermite.com  
21063 Cabot Blvd. Ste. #6 • Hayward, CA 94545  
(888) 322-8889 Office • (510) 661-4218 Fax

# Bid/Work Agreement & Authorization For Termite Control

CA State Lic. #PR4138

### I. AGREEMENT

OWNER/AUTHORIZED AGENT \_\_\_\_\_ DATE 6/11/09  
 PROPERTY ADDRESS 540 A 9TH AVE  
 CITY Menlo Park STATE CA ZIP 94025  
 INSPECTOR J. Robinson WORK DATE \_\_\_\_\_ TIME \_\_\_\_\_  
**TREATMENTS:**  
 Drywood Termite Cost: \$900.00  
 Subterranean Termite Cost: \$900.00  
 Preventive Cost: \$  
 Other \_\_\_\_\_ Cost: \_\_\_\_\_  
 Discount: \_\_\_\_\_  
 Total: \$1800.00  
 Down Payment: \$180.00  
 Balance Due Upon Completion: \$1620.00

DOWN PAYMENT MADE BY:  CASH  CHECK NO. \_\_\_\_\_  
 VISA  MASTER CARD  DISCOVER

ACCT. NO. \_\_\_\_\_ EXP. DATE \_\_\_\_\_

### II. WARRANTY

**THREE YEAR WARRANTY/ PRIMARY TREATMENT FOR DRYWOOD TERMITES** — This full structure warranty covers the treatment of drywood termites on the above-mentioned property for three (3) full years from the date of completion of original work. Any new or recurring drywood termite infestations noted during the warranty period will be treated by this company at no additional cost to the customer. This warranty is in effect only if full payment has been made on services rendered. There will be a \$50.00 fee for all inspections for escrow while the warranty is in effect.

**THREE YEAR WARRANTY I SECONDARY TREATMENT FOR DRYWOOD TERMITES**

— Same as above. Fumigation is not covered by this warranty.

**THREE YEAR WARRANTY I SUBTERRANEAN TERMITES** — This full structure warranty covers the treatment of subterranean termite infestations on the above mentioned property for three (3) full years from the date of completion of original work. Any new or recurring subterranean termite infestations noted during the warranty period will be treated by Hi Tech Termite Control at no additional cost to the customer. This warranty is in effect only if full payment has been made for services rendered. There will be a \$50.00 fee for all escrow inspections while the warranty is in effect

**ONE YEAR WARRANTY/SPOT TREATMENT**

For:  Drywood Termites only \_\_\_\_\_  Subterranean Termites only \_\_\_\_\_  
 Preventative Treatment \_\_\_\_\_  Other: \_\_\_\_\_  
 On:  Area(s) Only: \_\_\_\_\_

### III. EXTENDED WARRANTY

An extended warranty is available on this property if original warranty from this firm has not expired. The extended warranty shall commence after the primary or secondary warranty expires.

The extended warranty is available for renewal on a yearly basis and is transferable upon sale or transfer of the property.

Yearly cost of extended warranty: \$ 280.00 /year

This price is guaranteed for two years.

An extended warranty is not offered with the agreed treatment.

### IV. EXCLUSIONS & DISCLAIMERS

Our alternative system in and of itself is not a whole structure treatment. This bid does not include the repair, correction or treatment of fungus, dry rot, damage caused by water or plumbing leaks, exterior fences, structural or correctional repairs. These items may be noted on the inspection report, however they must be corrected by a licensed contractor of your choice. HI TECH TERMITE CONTROL OF THE BAY AREA, INC. will not assume any liability for any slab injection or any damage caused to any auxiliary connection that is embedded in concrete of any slab or foundation construction. The use of schematics and/or drawings does not imply or assume responsibility on the part of HI TECH TERMITE CONTROL OF THE BAY AREA, INC. Said documents are for information purposes only. **NOTE:** if your property requires drilling through concrete slabs, this firm will not be responsible for possible damage

### V. TYPE OF TREATMENT

- Primary Treatment for Drywood Termite Infestation(s) - Fumigate with lethal gas for the eradication of all drywood termite infestations. This treatment includes a three (3) year full structure warranty against all drywood termite infestations.
- Secondary Treatment for Drywood Termite Infestation(s) - Microwave and/or Termidor/ borate foam injection for the treatment of all drywood termite infestations, which may extend into wall voids. All accessible drywood termite infestations will be treated with boric acid/Termidor injections and/or a spray application of sodium borate oil for the control of drywood termite infestations. This treatment includes a three (3) year full structure warranty against all drywood termite infestations. Fumigation is not included with this treatment.
- Primary Treatment for Subterranean Termites - Permethrin or Termidor application to the soil where the subterranean termite infestation(s) are located. This will be completed by drilling through the slab or trenching along the foundation walls, for the control of subterranean termite infestations. This treatment includes a three (3) year full structure warranty against all subterranean termite infestation.
- Preventative Treatment for Drywood and Subterranean Termite Infestations - This treatment is a spray application of Tim-bor (sodium borate) to all accessible, unpainted wood within the structure (attics, subareas, garages, etc.) This treatment can be completed in conjunction with our primary or secondary treatment at an additional cost. Remove storage from attic and garage for spray application.
- Spot Treatment for Drywood Termite Infestations - Borate/Termidor application to accessible infestation (s) for the control of drywood termites. One (1) year warranty for the areas treated only Fumigation is not included with this treatment.
- Spot Treatment for Subterranean Termites - Permethrin application to the soil where the subterranean termite infestation(s) are located. This will be completed by drilling through the slab or trenching along the foundation walls for the control of subterranean termite infestation. One (1) year warranty
- Spot Treatment for Subterranean Termites - Termidor application to the soil where the subterranean termite infestation (s) are located. This will be completed by drilling through the slab or trenching along the foundation walls, (or the control of subterranean termite infestation.

### VI TERMS

Cash upon completion. Financing with VISA, Master Card or Discover is available. A ten percent deposit shall be required at the time job is ordered. VISA or Master Card is accepted same as cash. If job is postponed and HI TECH TERMITE CONTROL OF THE BAY AREA, INC is notified less than forty-eight hours prior to postponement, an additional ninety-five dollars will be added to the estimate. A cancellation fee of ten percent will be charged if job is canceled. Multi-Unit Complexes Note: All units must be accessible on work date scheduled. HI TECH TERMITE CONTROL OF THE BAY AREA, INC. is not responsible for inaccessible units and the balance will be due upon completion of accessible units. Inaccessible units will be treated after balance is paid in full.

**THIS QUOTE PRICE IS VALID FOR NINETY DAYS.**

**HI TECH TERMITE CONTROL OF THE BAY AREA, INC. is hereby authorized to treat my property for the control of the following wood destroying insects:**

Owner or Authorized Agent's Agreement \_\_\_\_\_ Date \_\_\_\_\_

**All work shall be done in a workmanship-like manner in accordance with all applicable codes**

### VII NOTICE

~~The charges for services that HI TECH TERMITE CONTROL OF THE BAY AREA, INC. subcontracts to another person or entity may include HI TECH TERMITE CONTROL OF THE BAY AREA, INC. charges for arranging and administering such services that are in addition to the direct costs associated with paying the subcontractor. Company's that may be subcontracted:~~

Name \_\_\_\_\_ Phone \_\_\_\_\_  
 Address \_\_\_\_\_

### VIII NOTICE OF OWNERS

Under the California Mechanics Lien Law, any Structural Pest Control Company which contracts to do work for you, any contractor, subcontractor, laborer, supplier or other person who helps to improve your property but is not paid or his or her work or supplies.